

# VIRTUAL ALL STAFF TOWN HALLS



May 17, 2023



Thunder Bay Regional  
Health Sciences  
Centre

Thunder Bay Regional  
Health Research  
Institute

# Virtual All Staff Town Hall

## 2:00 pm – 2:45 pm

### *Agenda for May 17*

- ▶ **Introduction** – *R. Crocker Ellacott*
- ▶ **Patient Story** – *C. Johnson*
- ▶ **Transitioning of COVID-19 Response Activities (Phase 3)** – *J. Wintermans*
- ▶ **Cardiovascular Surgery Project** – *W. Taylor*
- ▶ **UKG Dimensions: Next Steps** – *D. M. Perry and M. Iorianni*
- ▶ **Your Questions Answered** – *J. Wintermans*
- ▶ **Closing Remarks** – *R. Crocker Ellacott*

# Patient Story



Thunder Bay Regional  
Health Sciences  
Centre

Thunder Bay Regional  
Health Research  
Institute

Exceptional **care** for every patient, every time.

3

STRATEGIC PLAN

2026

# COVID-19 Response Activities – Phase 3 Transition

## Transition

- ▶ Phase 1 – March 31 ✓
- ▶ Phase 2 – April 21 ✓
- ▶ Phase 3 – May 25

## Masking

- ▶ Removal of universal masking
- ▶ Masking will only be mandatory when providing direct patient care and/or per IPAC protocols
- ▶ Masking continues to be encouraged
- ▶ Risk analysis and level of comfort
- ▶ Masks will always be available

When to wear → providing a patient medication, transporting a patient within the hospital, performing patient care

When not required to wear → When walking to Robins or the Cafeteria, when in an administrative department, when on a clinical unit outside a patient room and not in direct contact with a patient

# COVID-19 Response Activities – Phase 3 Transition

## ECP/CP Restrictions & Masking

- ▶ No longer mandatory Hospital-wide.
- ▶ Encouraged and supplied.
- ▶ May be requested to wear a mask in certain situations.
- ▶ Essential Care Partner, Care Partner & Family Presence Policy PAT-5-176 when communicating with patients and their ECP/CPs.
- ▶ Two people at the bedside at a time.
- ▶ Children – 2 allowed at any one time (one ECP/CP plus 2 children) max of 3 people at a time.



*Unit level decisions for all situations that fall outside of the policy*



Thunder Bay Regional  
Health Sciences  
Centre

Thunder Bay Regional  
Health Research  
Institute

Exceptional **care** for every patient, every time.



# COVID-19 Response Activities – Phase 3 Transition

## Return to Work Process

- ▶ RedCap App – no longer required to be completed.
- ▶ If you have symptoms - You no longer require a PCR test for COVID-19.
- ▶ If you have tested positive for COVID-19 – RTW when asymptomatic or improvement.
- ▶ If you have had a high-risk contact in the community – No report to OHS, follow work isolation protocols.
- ▶ If you have a high-risk COVID-19 exposure at work – Report to OHS by submitting an electronic incident report.



Thunder Bay Regional  
Health Sciences  
Centre

Thunder Bay Regional  
Health Research  
Institute

Exceptional **care** for every patient, every time.





Thunder Bay Regional  
Health Sciences  
Centre

# Update on Cardiovascular Surgery Project

# Summary Overview of Capital Planning Process

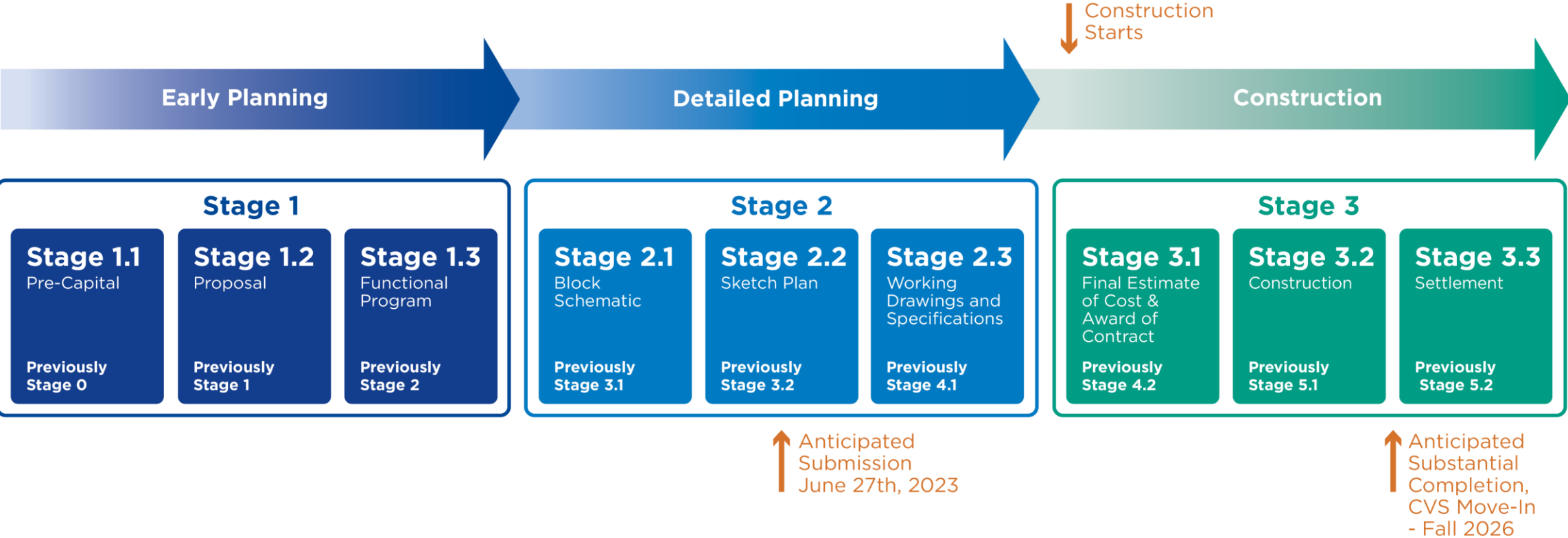

# Capital & Clinical Key Dates & Milestones



# Level 1 MDRD



## Level 2 Ambulatory Care and Vascular clinics

Electrocardiogram  
(ECG) &  
Phlebotomy  
Services



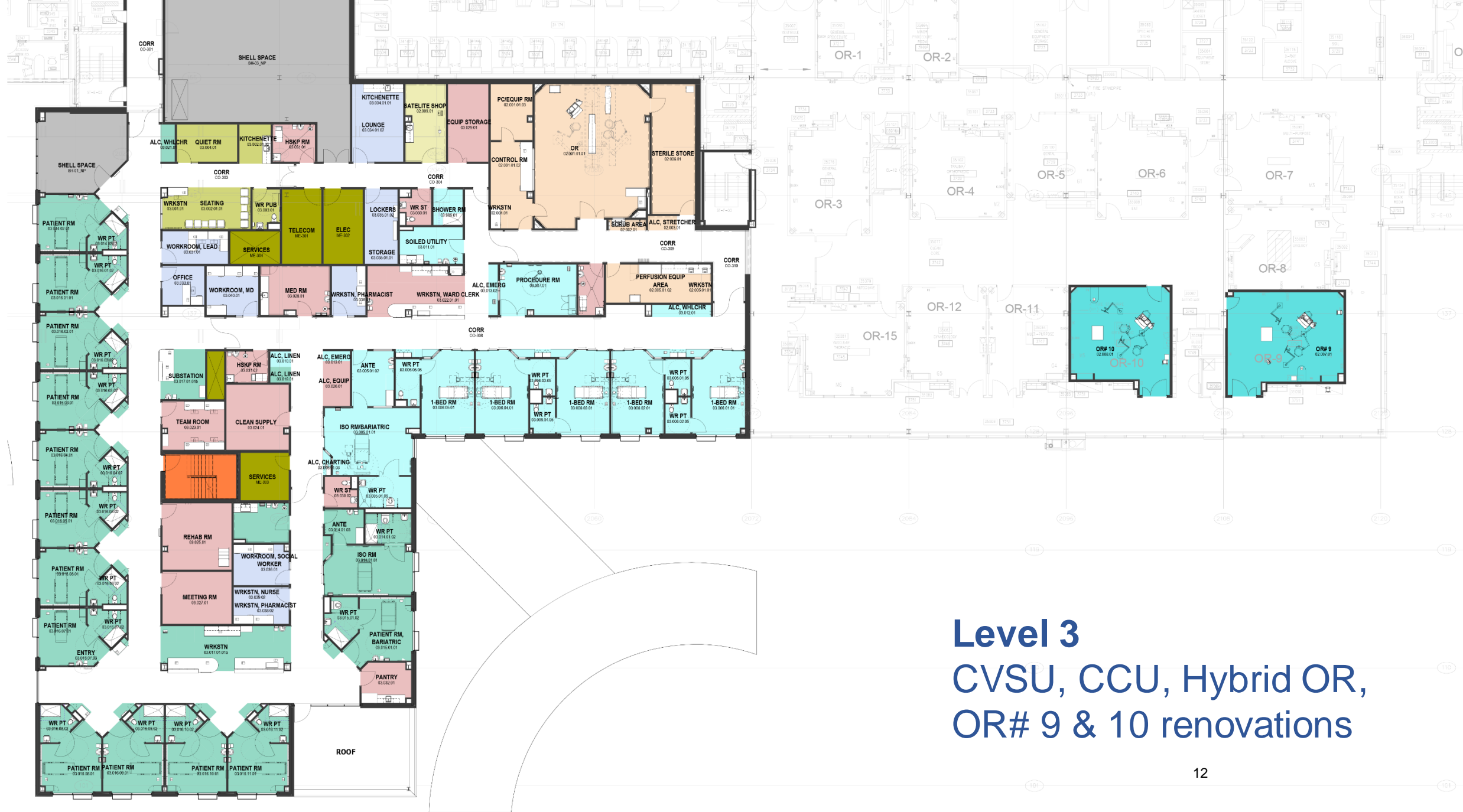

## Level 3

### CVSU, CCU, Hybrid OR, OR# 9 & 10 renovations













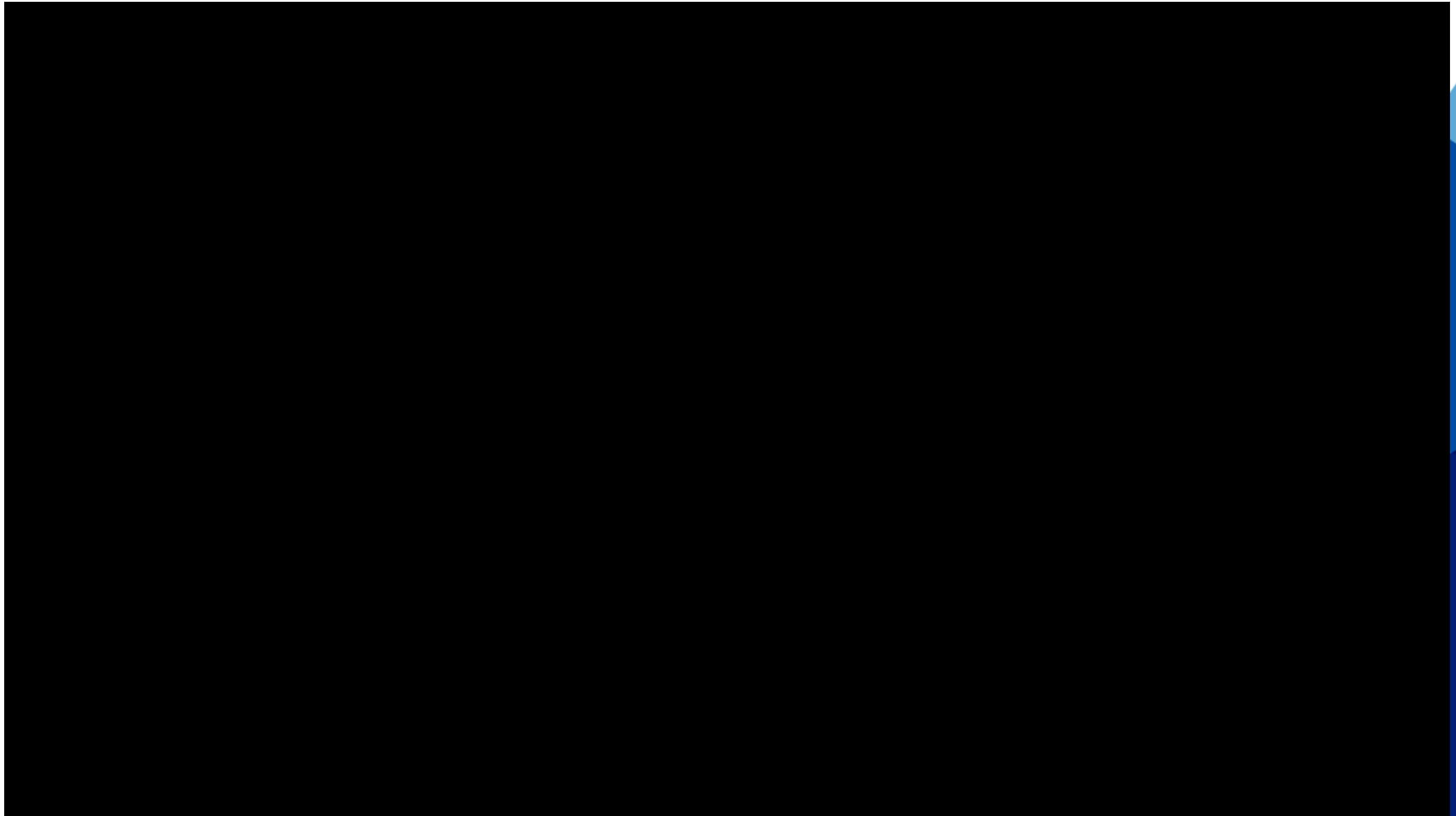





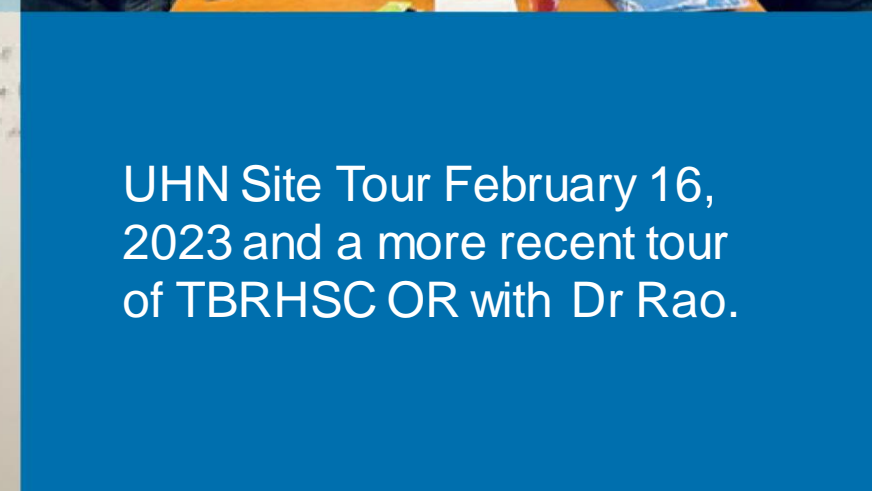

UHN Site Tour February 16, 2023 and a more recent tour of TBRHSC OR with Dr Rao.

# UKG Dimensions - Andgo

## Timeline

2022-23

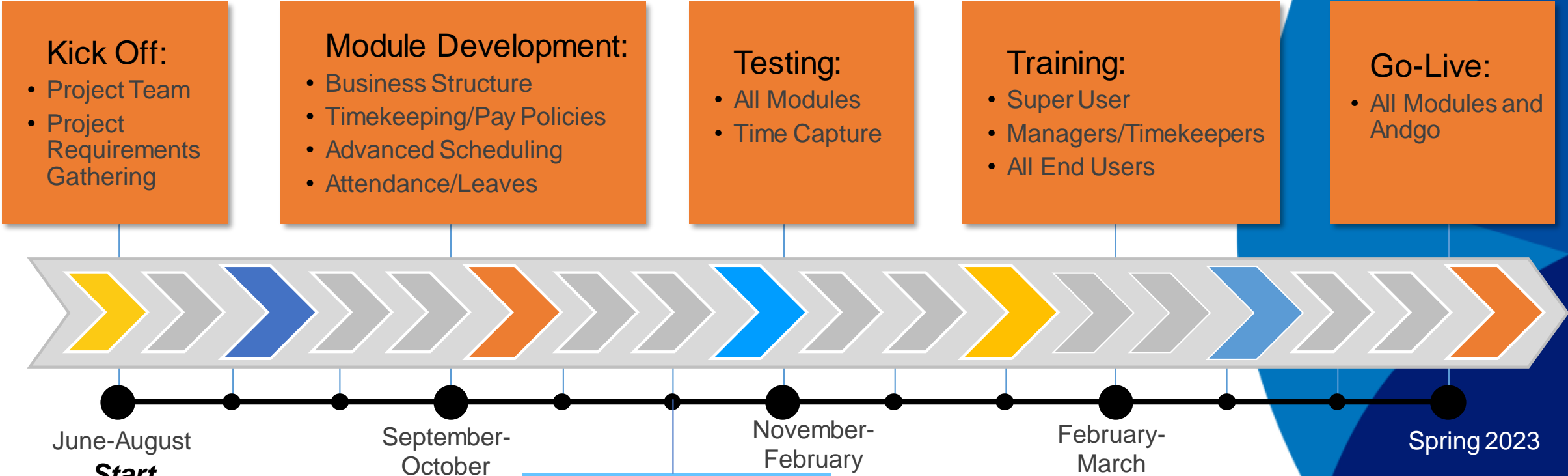

Thunder Bay Regional  
Health Sciences  
Centre

Thunder Bay Regional  
Health Research  
Institute

**Concurrent Project Launch:**  
Andgo Smart-Call for units  
serviced by SO

Exceptional **care** for every patient, every time.

STRATEGIC PLAN

2026

# What we are working on

- ▶ Integration with existing Human Resources and payroll system
- ▶ Time Capture
- ▶ Position control
- ▶ Testing sign-off
- ▶ Training



Thunder Bay Regional  
Health Sciences  
Centre

Thunder Bay Regional  
Health Research  
Institute

Exceptional **care** for every patient, every time.

STRATEGIC PLAN

2026

# UKG Dimensions - Andgo

## *Revised Timeline*

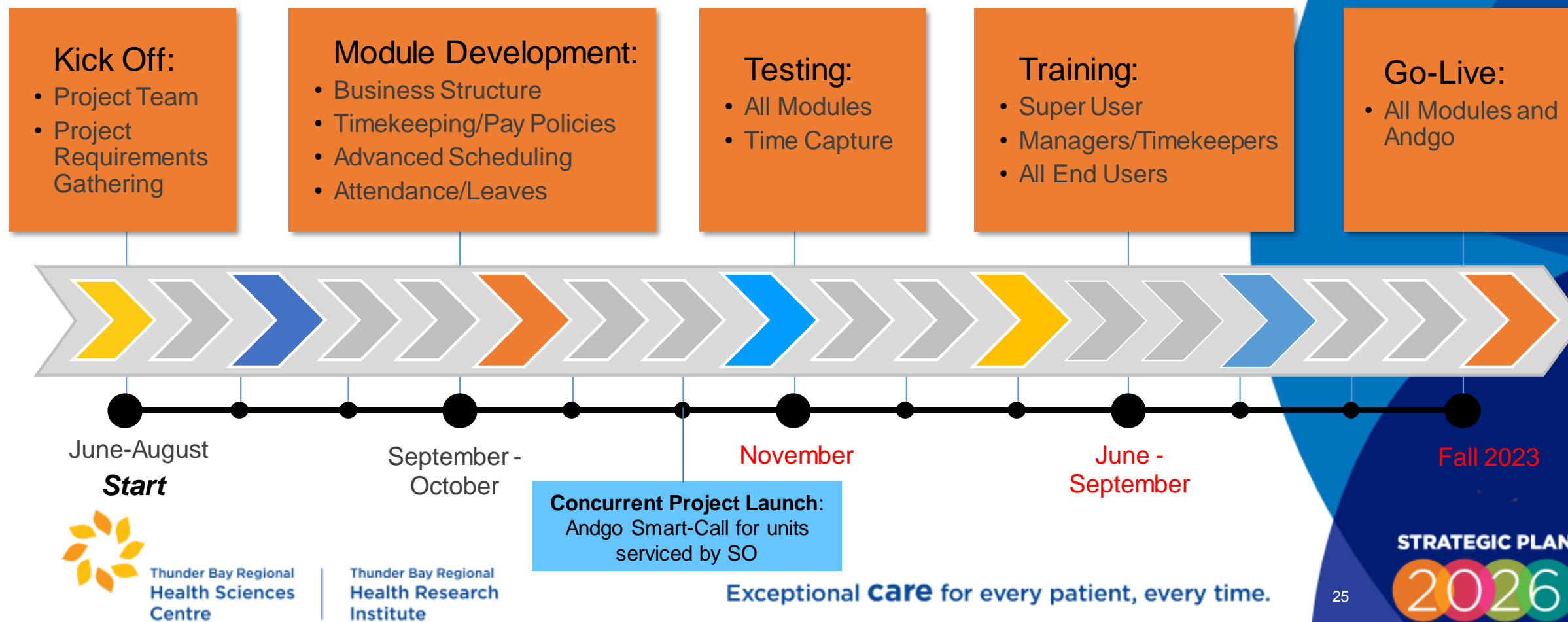

# UKG Implementation Core Team

Please reach out to anyone of our team members at anytime:

- ▶ **Dino Armenti** – *Co-Project Sponsor*
- ▶ **Dawna Maria Perry** – *Co-Project Sponsor*
- ▶ **Rita Grenier Buchan** – *Project Lead - Scheduling*
- ▶ **Michael Iorianni** – *Project Lead - Payroll*
- ▶ **Carrol Wenzell** – *Payroll Subject Matter Expert*
- ▶ **Monique Trudeau** – *HR Subject Matter Expert*
- ▶ **Cora Rouillard** – *Integration Subject Matter Expert*
- ▶ **Laura Macgowan** – *HR/Leaves Subject Matter Expert*
- ▶ **Sharen Howarth** – *HR/Leaves Subject Matter Expert*
- ▶ **Angela Kutok** – *PI Consultant – Project Manager*

# Questions?



Thunder Bay Regional  
Health Sciences  
Centre

Thunder Bay Regional  
Health Research  
Institute

Exceptional **care** for every patient, every time.

STRATEGIC PLAN

2026

# Closing Remarks



Thunder Bay Regional  
Health Sciences  
Centre

Thunder Bay Regional  
Health Research  
Institute

Exceptional **care** for every patient, every time.

STRATEGIC PLAN

2026